

### DATOS TÉCNICOS

#### DATASHEET

**MARCA / BRAND:** ELECTRO DH  
**CÓDIGO / CODE:** 15.473  
**DESCRIPCIÓN:** BASE DE ALIMENTACIÓN  
**DESCRIPTION:** BASE OF FEEDING



#### ESPECIFICACIONES TÉCNICAS TECHNICAL SPECIFICATIONS

|                                 |   |
|---------------------------------|---|
| <b>Voltaje nominal:</b>         | <b>30 VDC.</b>                              |
| <b>Rated voltage:</b>           | <b>30 VDC</b>                               |
| <b>Corriente máxima:</b>        | <b>0'3 A.</b>                               |
| <b>Maximun current:</b>         | <b>0'3 A.</b>                               |
| <b>Resistencia de contacto:</b> | <b>50 mΩ máximo</b>                         |
| <b>Contact resistance:</b>      | <b>50 mΩ maximun</b>                        |
| <b>Resistencia aislante:</b>    | <b>100 mΩ a 500 VDC</b>                     |
| <b>Insulation resistance:</b>   | <b>100 mΩ to 500 VDC</b>                    |
| <b>Rigidez dieléctrica:</b>     | <b>500 VAC durante 1 minuto</b>             |
| <b>Dielectric strength:</b>     | <b>500 VAC for 1 minute</b>                 |
| <b>Ciclos de vida:</b>          | <b>5.000 ciclos</b>                         |
| <b>Lifecycles:</b>              | <b>5.000 cycles</b>                         |
| <b>Cuerpo (1):</b>              | <b>Tereftalato de polibutileno (PBT)</b>    |
| <b>Body (1):</b>                | <b>Polybutylene terephthalate (PBT)</b>     |
| <b>Terminales:</b>              | <b>Latón plateado</b>                       |
| <b>Terminals:</b>               | <b>Brass plated</b>                         |
| <b>Placa de resorte:</b>        | <b>Acero inoxidable</b>                     |
| <b>Spring plate:</b>            | <b>Stainless steel</b>                      |
| <b>Pin central:</b>             | <b>Aleación de cobre niquelado Ø 1,95mm</b> |
| <b>Center pin:</b>              | <b>Nickel-plated copper alloy Ø 1,95mm</b>  |
| <b>Grado de inflamabilidad</b>  | <b>V-0</b>                                  |
| <b>Degree of flammability</b>   | <b>V-0</b>                                  |

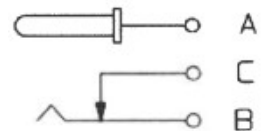
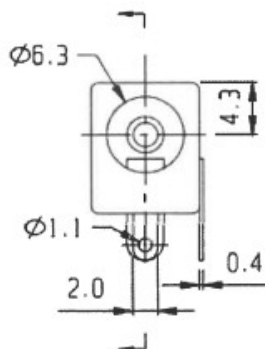
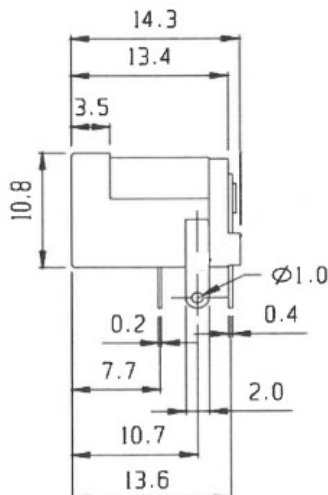

**ELECTRO DH s.a.**

Fortuna 29  
08902 Hospitalet de LL (BCN)

